

REVERSO

VALVOLA A SFERA CON ATTACCO MULTISTRATO BALL VALVE WITH MULTILAYER PIPE CONNECTION

S0222 REVERSO

NEW



CODICE CODE	MISURA SIZE	LEVA LEVER	PN Bar	øA	B	C	D	E	F	G	H	SW	Box Crt
S0222N06	1" x 1" (DN20)	ROSSA Red	40	20	43,5	44	11,5	59,4	26,3	37	38,2	34	10/50
S0222B06	1" x 1" (DN20)	BLU Blue	40	20	43,5	44	11,5	59,4	26,3	37	38,2	34	10/50

Temperatura: - 20°C/+100°C
Temperature: - 20°C/+100°C

Valvola a squadra nichelata con sfera teflonata con attacco M/M, levetta frontale. (Tenuta O-Ring).
Angle ball valve male/male connection with teflon-coated ball, lever, nickel-plated.

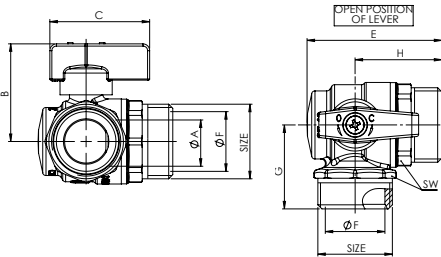

S3222 REVERSO

NEW



CODICE CODE	MISURA SIZE	LEVA LEVER	PN Bar	øA	B	C	D	E	øF	SW	Box Crt
S3222N06	1" x 1" (DN20)	ROSSA Red	50	20	43,5	44	11,5	80	26	34	10/50
S3222B06	1" x 1" (DN20)	BLU Blue	50	20	43,5	44	11,5	80	26	34	10/50

Temperatura: - 20°C/+100°C
Temperature: - 20°C/+100°C

Valvola a squadra nichelata con sfera teflonata con attacco M/bocchettone, levetta blu. (Tenuta O-Ring).
Angle ball valve male/pipe connection with teflon-coated ball, blue lever, nickel-plated.

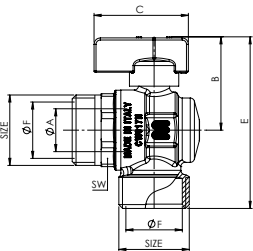

S3221 REVERSO

NEW

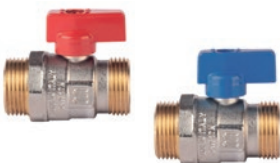

CODICE CODE	MISURA SIZE	LEVA LEVER	PN Bar	øA	B	C	D	E	øF	SW	Box Crt
S3221N06	1" x 1" (DN20)	ROSSA Red	50	20	43,5	44	11,5	70	26	34	10/50
S3221B06	1" x 1" (DN20)	BLU Blue	50	20	43,5	44	11,5	70	26	34	10/50

Temperatura: - 20°C/+100°C
Temperature: - 20°C/+100°C

Valvola a squadra nichelata con attacco M/M, con sfera teflonata. (Tenuta O-Ring).
Angle ball valve male/male connection with teflon-coated ball, lever, nickel-plated.

